

GaugeCalHP

» **GaugeCalHP** is a self-contained, precision hydraulic pressure comparator intended for the calibration of pressure gauges, transmitters, sensors, and safety valves rated up to 15 000 psi / 1000 bar. You may fill the comparator with your choice of oil, water, or air.

The GaugeCalHP is much faster than deadweight testers and most automated pressure controllers; and it's so quick and easy to use, it's ideal for calibrating those low cost gauges that are often overlooked for ISO9000 compliance.

Key Features

- a Fine Adjust**
Easy to use, even at 15 000 psi.
- b Reservoir**
Clear, removable reservoir with a fill line.
- c Pivot Manifold**
Manifold rotates for testing large size gauges.
- d Connection Fitting**
With easy alignment swivel capability.
- e Reservoir Knob**
Generates low pressure to bleed the system.
- f No Mess Drip Tray**
Captures fluid when bleeding the system.
- g Travel Indicator**
Shows available stroke.
- h Brackets**
For easy mounting to a table top.
- i Removable Handle Assembly**
Easily removes for transport. Includes captive screw.

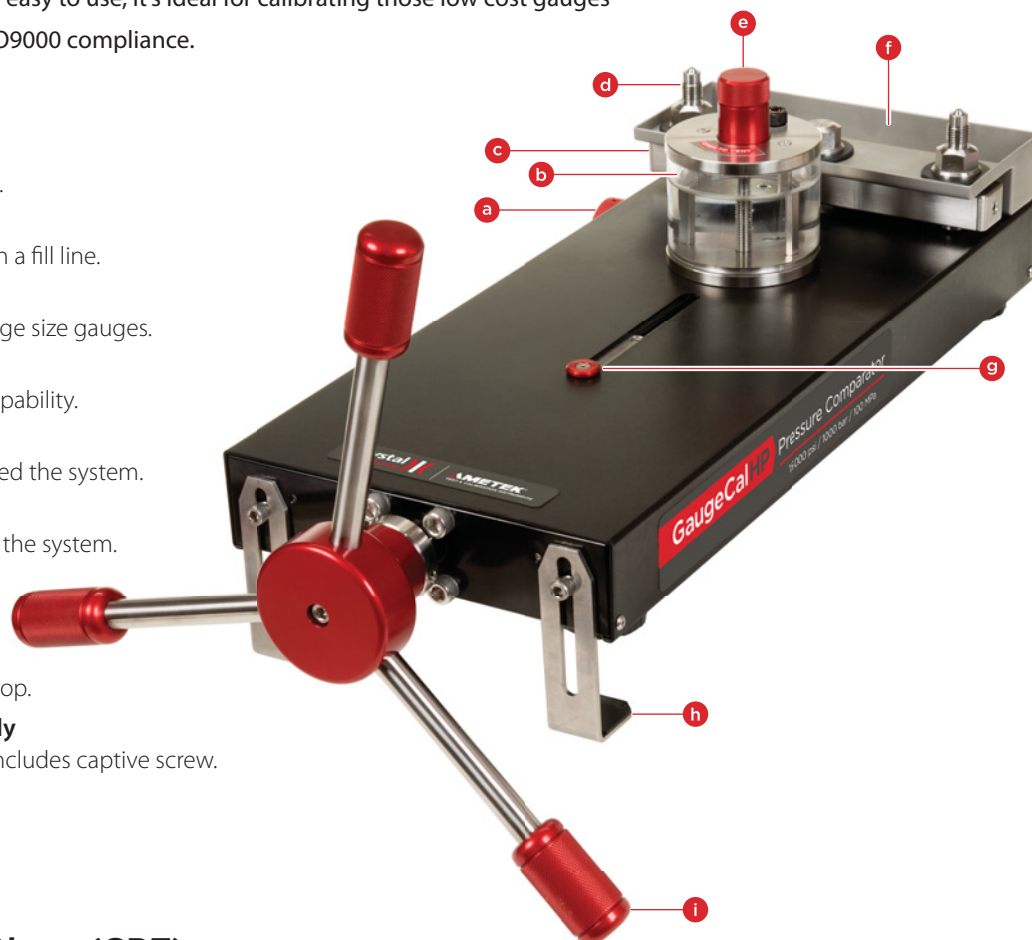

CPF

» **Crystal Pressure Fittings (CPF)** are machined in high strength 316 Stainless Steel to operate with a 4:1 Safety Factor at 10 000 psi / 700 bar.



Key Features

- **Purpose-Designed**
For testing and calibration.
- **Self-Venting Weep Hole**
Assures a safe disconnection from a pressurized system.
- **2 Ways to Seal**
Use fingers for an o-ring seal or use a wrench for a metal to metal cone seal.
- **Laser Marked**
Laser markings indicate the thread type, part number, and MAWP.
- **Interchangeable**
For use with HIP and Autoclave Engineers medium pressure (1/4") series fittings and adapters.

GaugeCalHP

Operation

Pressure can be set very quickly and precisely. Gauges can be calibrated in less than two minutes with 5 to 10 test points, increasing and decreasing pressure. The comparator can be filled with oil, water, or even air, allowing for clean and safe calibration of most gauge types.

■ Connect Gauges

Connect a reference grade gauge (an XP2i or nVision) on one port and the gauge to be tested on the second port.

■ Apply Pressure

Rotate the handle clockwise until the desired pressure is generated.

■ Compare

Compare the displayed pressure values between the reference gauge and the gauge under test.

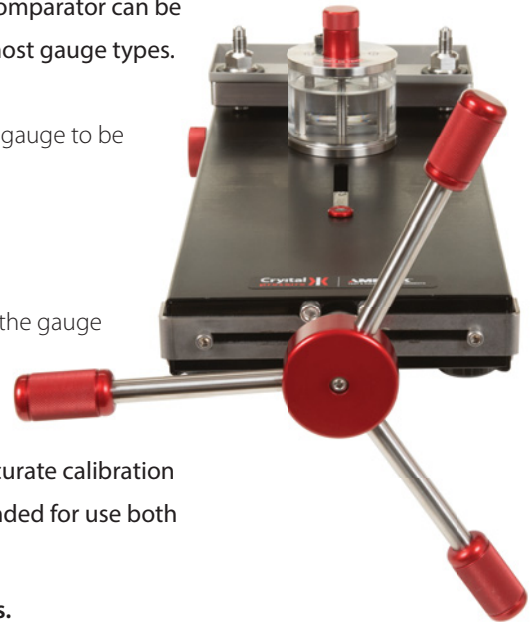

Applications

The GaugeCalHP is appropriate for use in any industry that requires the accurate calibration of gauges, transmitters, sensors, and safety valves. The GaugeCalHP is intended for use both in the lab and in the field.

- Low cost replacement for hydraulic ram screws on deadweight testers.
- Ideal for calibrating low cost gauges that are often overlooked for ISO9000 compliance.
- Continuous vacuum to pressure generation is great for compound range devices.

CPF

Applications

Crystal Pressure Fittings (CPF) are leak-free up to 10 000 psi/700 bar /70 MPa. Should your o-ring leak in the field (due to chemicals or wear), simply pull it out and replace it, or use a wrench to create a metal-metal seal. Crystal pressure fittings are designed for any application and environment where safety and integrity of equipment is of paramount importance.

2 Ways to Seal

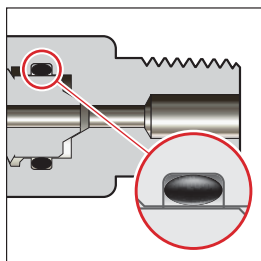

CPF to CPF O-ring seal.
Finger-tight up to 10 000 psi.

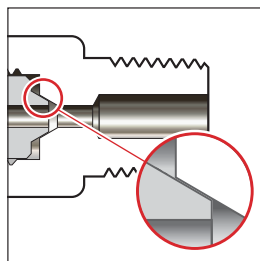

CPF to non-CPF metal seal.
Use a wrench to create a seal.

Flexible, Lightweight Hose

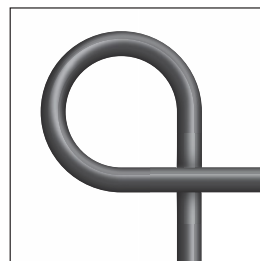

Minimum 1" (2.5 cm) bend
radius, even under pressure.

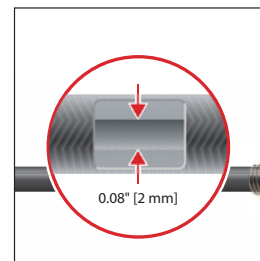

Small inner hose diameter
reduces pumping effort and
saves time.