

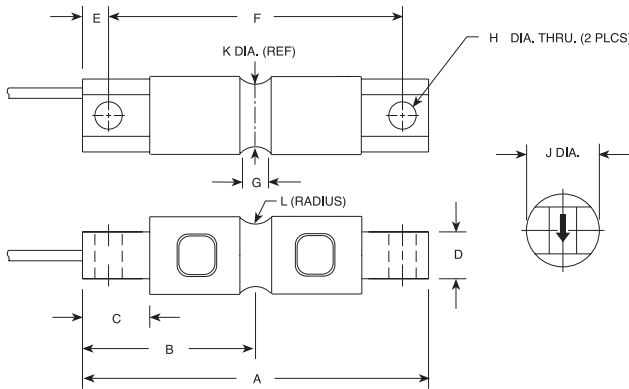

Visit us at [Transcat.com!](http://Transcat.com)
35 Vantage Point Drive // Rochester, NY 14624 // Call 1.800.800.5001



Picture is a representation of actual product



SPECIFICATIONS:

Full Scale Output:	3.0 mV/V
Bridge Resistance:	700 ohms, nominal
Material/Finish:	Stainless steel
Temperature:	Compensated range 0°F to 150°F/-18°C to 65°C
Safe Overload:	150% Full scale
Safe Sideload:	100% Full scale
Rated Excitation:	10V AC/DC (15V max)
Non-repeatability:	0.02% Full scale
Combined Error:	0.1% Full scale
Insulation Resistance:	5000 megohms
Deflection at Capacity:	5000 lb = .02"/.5 mm, 10,000 lb = .025"/.6 mm, 20,000 lb = .042"/1.1 mm, 30,000-50,000 lb = .02"/.5 mm, 60,000 lb = .025"/.6 mm, 100,000-150,000 lb = .02"/.5 mm
Seal Type:	Environmentally sealed, IP67
Cable Length:	30'/9.2 m
Cable Color Code:	Red..... + Excitation Black..... - Excitation Green..... + Signal White..... - Signal Orange..... Shield
Warranty:	Two-year limited warranty
Approvals:	

DIMENSIONS

Rated Capacity	A	B	C	D	E	F	G	H	J	K	L
lb/inches											
5000-10,000	8.12	4.06	1.44	1.12	.62	6.88	.62	.66	1.83	1.48	.50
20,000	8.12	4.06	1.44	1.12	.84	6.88	.84	.66	2.08	1.48	.50
30,000-60,000	10.25	5.12	1.88	2.37	.88	8.50	1.00	1.06	3.20	2.73	1.00
100,000	11.25	5.62	1.88	2.50	.88	9.50	1.00	1.06	3.75	3.24	1.50
150,000	11.25	5.62	1.88	2.80	.88	9.50	1.25	1.06	3.90	3.64	1.50
kg/mm											
2268.0-4535.9	206.3	103.1	36.6	28.5	15.8	174.8	15.8	16.8	-55.9	37.6	12.7
9071.9	206.3	103.1	36.6	14.2	21.3	174.8	21.3	16.8	52.8	37.6	12.7
13,607.8-27,215.6	260.4	130.1	47.8	60.2	22.4	215.9	25.4	26.9	81.3	69.3	25.4
45,359.4	285.8	142.8	47.8	63.5	22.4	241.3	25.4	26.9	95.3	82.3	25.4
68,093.1	285.8	142.8	47.8	63.5	22.4	241.3	31.8	26.9	95.3	92.5	38.1

RL7000 SS Order Information

Rated Capacity	Part #	Price
5000 lb (2268.0 kg)	30431	Consult
10,000 lb (4535.9 kg)	30432	Consult
20,000 lb (9071.9 kg)	30433	Consult
30,000 lb (13,607.8 kg)	30434	Consult
40,000 lb (18,143.7 kg)	30435	Consult
50,000 lb (22,679.6 kg)	30436	Consult
60,000 lb (27,215.5 kg)	30437	Consult
100,000 lb (45,359.2 kg)	30444	Consult
150,000 lb (68,038.9 kg)	30445	Consult

Conduit Adapter Kit* (must be factory installed to maintain warranty)

3/8-24 Nipple	31533*	Consult
3/8-24 to 1/4-18 NPT	31534*	Consult
5/8-18 UNF/1/2-14 NPT	31535**	Consult

Interchangeable Products

Manufacturer	Model	Page #
Rice Lake Weighing Systems	RL71000 HE	134
Vishay Revere Transducers	9103	267
Artech	SS70210	

Weigh Module Available

Model	Page #
EZ Mount 1	62

* On capacities of 5000 to 20,000 lb, part #31534 must be installed together to form the Conduit Adapter Kit

** On capacities of 30,000 to 150,000 lb, order part #31535