

Pomona[®]

TRANSCAT

▶ Visit us at Transcat.com!

35 Vantage Point Drive Rochester, NY 14624
Call 1.800.800.5001

Model 5169 Do-It-Yourself In-Line Banana Plug With Flexible Boot

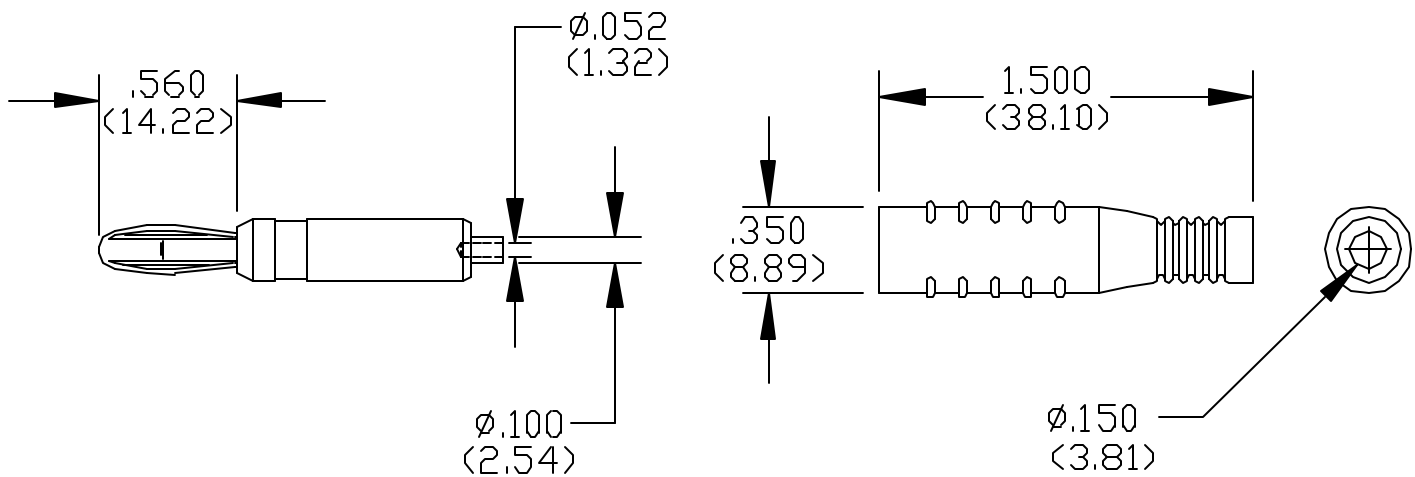

FEATURES:

- This in-line banana plug is ideal for making patch cords and field repairs.
- A snap-on two piece design allows the wire to be crimped or soldered to the banana plug.
- Parts will accept 18, 20, 22 AWG. Wire, crimp or solder connection.
- Use with Model #5167 to build a custom extension cable.

MATERIALS:

In-Line Banana Plug

Plug body: Brass per QQ-B-626, Alloy 360, ½ Hard

Spring: Beryllium copper per ASTM B194, Alloy 172, Cond. HT.

Insulation: Flexible PVC. Color: See Ordering Information

Marking: "POMONA"

Finish: Banana Plug – Nickel plated per QQ-N-290, Class 2, 200/300 micro-inches.

Rating: (Independent of Wire)

Operating Temp. +50°C. (+122°F.) Max.

Voltage: 5000 VDC

Current: 15 Amperes

RATINGS: (Independent of Wire)

Operating Temperature: +50°C. (+122°F.) Max.

Voltage: Hand-held testing 30VAC/60VDC Max.

Hands free testing in controlled voltage environments: 5000 WVDC Max.

Current: 15 Amperes

ORDERING INFORMATION: Model 5169-*

*= Color, -0 Black, -2 Red

Ordering example: 5169-0, Color is Black

Other colors available on special request.

All dimensions are in inches. Tolerances (except noted): .xx = ±.02" (.51 mm), .xxx = ±.005" (.127 mm).

All specifications are to the latest revisions. Specifications are subject to change without notice.

Registered trademarks are the property of their respective companies. Made in USA

TRANSCAT

▶ Visit us at Transcat.com!

35 Vantage Point Drive // Rochester, NY 14624 // Call 1.800.800.5001